

Heavy-Duty Impact Sled



Thank you for purchasing the Heavy-Duty "Impact" Sled from BigSprinkler.com. These sled based sprinklers will provide you with a commercial grade solution for residential sized projects such as irrigating medium sized lawns, gardens, playgrounds, horse riding arenas, and much more!

Your sled comes our new R3S Max Drive impact sprinkler also comes with a full set of nozzles allowing flow ranges from 3 to 8 gallons per minute. This sprinkler also features an adjustable jet stream breaker for changing stream pattern and may be operated in full circle mode or part circle mode by simply adjusting the part circle tabs at the base of the sprinkler. This quality sprinkler is constructed from a cast aluminum alloy body with brass lower turning union. The Max Drive action of this sprinkler uses the perfect combination of drive arm spring tension and engineered mechanical designs to display a beautiful stream pattern in forward and fast reverse mode that results in the absolute best wetted water pattern all throughout the diameter of the circle. The Max Drive stays consistent at low and high pressures.

The Impact sled also features a Flow-Through Base design allowing multiple sled bases to be connected in series!

We also offer accessories such as 3/4" garden hoses, larger pre-made hose kits with quick connects for easy hook-up and booster pumps that will greatly enhance pressure and performance for your sprinkler sled.

The following manual is a guide for assembly, setup, and operation of your new BigSprinkler Sled. Please read and follow all instructions carefully.

Impact Sled Performance



Specifications:

- **Inlet Size:** Garden Hose Connection
- **Flow Rates:** 3 – 11 GPM
- **Available Nozzles:** 4mm, 5mm, 6mm
- **Pressure Range:** 25 - 60 PSI

Heavy Duty Impact Sled Performance Chart

R3S Max Drive (30° Trajectory) 0.75" FNPT Connection

PSI	Nozzle 4mm (.16")		Nozzle 5mm (.20")		Nozzle 6mm (.24")	
	GPM	Diameter	GPM	Diameter	GPM	Diameter
25	3.4	77	5.2	82	8	88
30	3.8	80	5.9	85	9	92
35	4	82	6.4	89	9.5	96
40	4.2	85	7.2	92	10	99
45	4.7	87	7.5	95	10.5	102
50	5	90	7.8	98	11	104

Accessories



Garden Hose



Hose Kits & Fittings



Booster Pumps

Sled Assembly Instructions

Please read this manual carefully and follow all safety and assembly instructions below to ensure that your cart is assembled correctly and operates properly upon start-up. If you have any questions please call 1-855-805-7901.



Safety



Safety is the main priority and failure to follow these instructions may cause serious injury. BigSprinkler.com is not responsible for product failure, property damage, or personal injury if these procedures and operation instructions are not followed.

- **Beware of electric power lines**

Irrigation water should never contact electric power lines or any other power source. Never let any part of the sprinkler cart or any irrigation fittings or pipe come in contact with an electric power source.

- **Use caution up close to operating sprinkler heads**

Pressurized water from the sprinkler head could cause serious damage to people or objects. Never allow small children to play close to operating sprinkler heads!

Step 1



Step 1) Unpack contents from box. The sprinkler sled is shipped with two main components; the Sled Base, and sprinkler head.

Step 2



Step 2) Attach sprinkler head to the threaded connection on the top of the sled base as shown and slowly rotate to the right to start the threads and hand tighten. Secure sprinkler head by tightening with an open end wrench or pipe wrench. **CAUTION:** Only tighten sprinkler head by placing wrench on the lower base area of the sprinkler head to avoid damage to upper portion of the sprinkler.

Step 3



Step 3) Position sprinkler sled in area to be watered. First be sure to allow water to flush any debris from your hose that might clog the sprinkler before attaching your hose to the sled. Finally attach your garden hose to the brass swivel on your sled and your new sprinkler sled is ready for operation.

Impact Sprinkler Adjustment

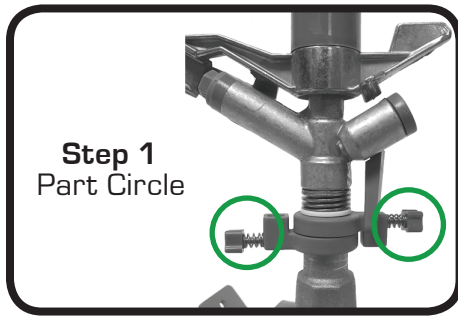

Step 1) Setting your Sprinkler head for Full Circle or Part Circle Operation
For “Full Circle” operation, loosen sprinkler stop, set screws as shown, and slide stops all the way down the brass sprinkler base so the reverse lever on the back of the sprinkler head does not make contact with the stops as it rotates. Retighten set screws to hold the stops in place. This will allow the sprinkler head to operate in a full circle mode.

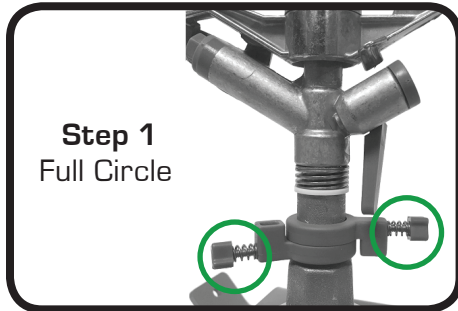

For “Part Circle” operation, loosen sprinkler stop set screws as shown and slide both stops all the way up. Rotate the stops apart from each other to achieve the desired part circle coverage before tightening the set screws to lock the stops in place.



Step 2) IMPORTANT: REVERSE VS. FORWARD MODE

If you set the sprinkler head for full circle operation, the reverse lever will either stay to the right or left for reverse or forward mode. Typically when using the sprinkler in full circle operation, you will want the sprinkler to be set in forward mode or a clockwise operating direction. For this to occur, you want the reverse lever at the back of the sprinkler to be over to the left as shown. If the lever is set to the right, the sprinkler will be in reverse mode. In reverse mode, the sprinkler will operate rapidly in a counterclockwise direction and your distance of throw will be less than it would be in forward mode.

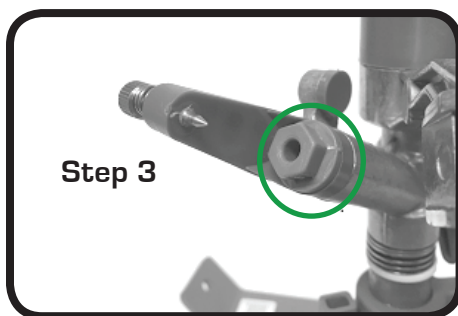

Step 3) Changing Nozzles: Your sprinkler head is supplied with a set of nozzles that are interchangeable to meet your water source’s capability. It is shipped with the smallest nozzle installed. If your water system operates the small nozzle adequately then, you may move up to a larger nozzle size for increased performance. The nozzle sizes listed on your supplied performance charts have gallons per minute output that tally at various pressures and wetted patterns that correspond. This may be a trial and error exercise to determine which nozzle size gives you the best desired performance when matched to your water source’s capability. If you are on well water then you may feel more comfortable consulting your servicing well dealer for help with your system’s capability if desired performance is not being met.

It may also be necessary to purchase a booster pump from our pump section of BigSprinkler.com if pressure boosting is needed.

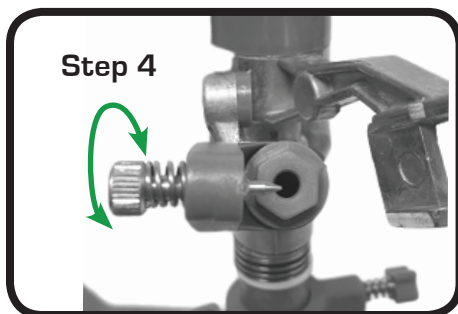

Step 4) Adjusting the sprinkler spray with the “Diffuser Screw”

Turning the diffuser screw to the right as shown will cause the tip of the screw to cross into the path of the water spray. Doing this will help break the stream pattern to allow for more of an even coverage if needed along with reducing the overall spray distance.

Warranty

LIMITED WARRANTY AND REMEDY:

WARRANTY

BigSprinkler.com warrants to the original purchaser only of the products described in the face hereof as of the date of the original invoice, that the product is merchantable and free from defects in material and workmanship.

Warranty shall be provided by the original manufacturer of products sold on BigSprinkler.com for the length of time specified by the manufacturer of the given product.

Sprinkler stands - 1 year

Sprinkler heads - 1 year

REMEDY

If BigSprinkler.com determines that the above warranty was breached with respect to any part or component provided by the manufacturer of the product (and if all conditions set forth below have been satisfied) then, BigSprinkler.com will (at BigSprinkler.com's option) provide purchaser a refund of the purchase price less the freight costs to or from the customer, or provide a replacement product of the same kind.

All remedies provided herein are for goods only, no labor or freight allowance for return goods is implied.

This warranty extends only to the original purchaser of products purchased from BigSprinkler.com.

CONDITIONS TO ENFORCEABILITY AND CLAIMS:

1. Product has been maintained and operated within the guidelines outlined in the manufacturer's product guide and maintenance manual.
2. Product warranty shall be considered void if any component or function of the equipment has been altered in any form other than what has been provided or intended by the original product manufacturer.
3. Any return must be submitted on form provided by BigSprinkler.com in writing immediately and in no event longer than 20 days from occurrence. You can reach our sales department through the "contact us" form on our website should such an event occur.
4. Purchaser must return all goods within 30 days of BigSprinkler.com's authorization date, that have been determined by BigSprinkler.com to be defective to the Purchaser with Purchaser being responsible for freight.

LIMITATIONS:

BigSprinkler.com or it's affiliates shall not be liable for any incidental or consequential damages (including but not limited to, damages for injury to the person, property or lost turf, crops or profits) by reason of any defect in the products sold or its manufacture, design, or function.